

## NOCCHI A-DHR

### PUMPS WITH ELECTRONIC CONTROL AND PROTECTION DEVICE

Automatic unit to increase the pressure in the water system.

Consisting of a single phase pump like DHR and of the electronic device FLUSSCONTROL, which controls the automatic operation of the pump and protects it in case of a lack of water.

#### APPLICATIONS

- Lifting and distribution of water in domestic systems
- Pressurization systems.
- Washing and irrigation.

#### CONSTRUCTION FEATURES

- Restart pressure not adjustable: 1.5 bar
- Temperature range of the liquid from 4°C to 65°C
- Power cable 1.5m H07 RN-F with schuko plug

#### USAGE DATA

- Type of liquid: clean water without suspended solids or abrasive material.
- Maximum recommended intake height: 6 m with bottom valve.
- Maximum operating pressure: 10 bar.

#### MOTOR

- Closed, ventilated from outside.
- Degree of protection IP 54.
- Insulation class F.
- Single-phase power supply with capacitor always on.
- Thermal protection built into the motor casing.
- Speed of rotation 2850 rpm.
- Continuous service.



#### TABLE OF MATERIALS

Component		Material
1	Pump body	Cast iron GJL 200 (ASTM Class 35)
2	Motor casing	Cast aluminium
3	Impellers	Stainless steel X5 CrNi18-10 (AISI 304)
4	Diffusers	Stainless steel X5 CrNi18-10 (AISI 304)
5	Sleeve	Stainless steel X5 CrNi18-10 (AISI 304)
6	Shaft	Stainless steel X5 CrNi18-10 (AISI 304)
7	Seals / Gaskets	NBR
8	Mechanical seal	Graphite / Ceramic

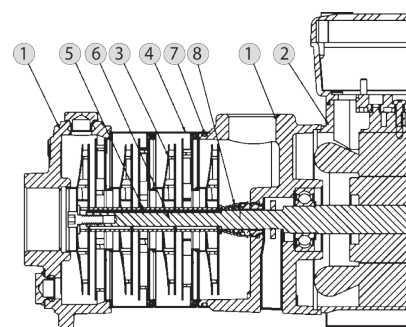

# NOCCHI A-DHR

## PUMPS WITH ELECTRONIC CONTROL AND PROTECTION DEVICE

### HYDRAULIC PERFORMANCE

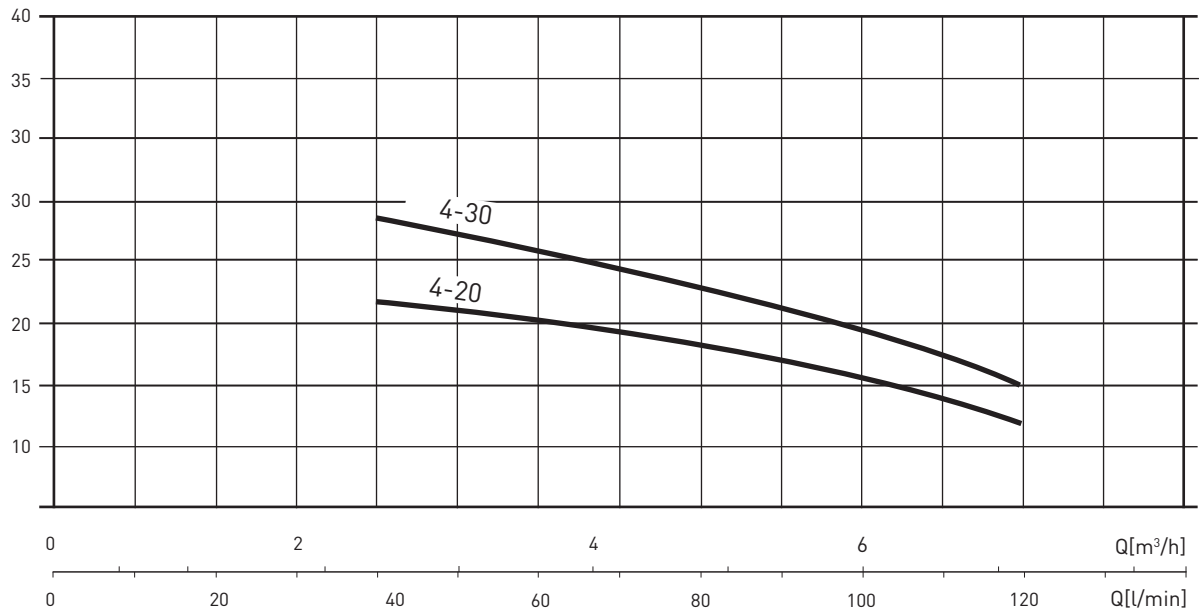

### PERFORMANCE TABLE

MODEL	Motor power (P2)		Motor power (P1)		VOLT. (V)	I <sub>n</sub> (A)	μF	Q	l/min	40	50	60	80	100	120
	HP	kW	HP	kW					m³/h	2.4	3	3.6	4.8	6	7.2
A-DHR 4-20 FB	0.50	0.37	0.80	0.60	1 ~ 230	2.9	12.5	m.c.a. / m.c.w.	17	16	15.5	13.5	11	7.5	
A-DHR 4-30 FB	0.70	0.50	1.10	0.80	1 ~ 230	3.7	12.5		23.5	22.5	21	18	14	10	

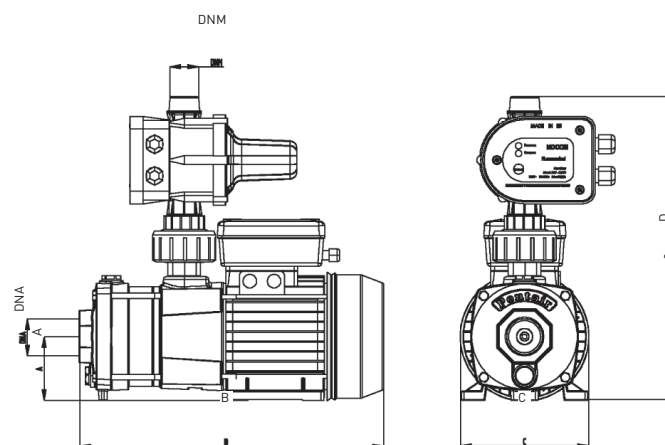

### OVERALL DIMENSIONS AND WEIGHTS

MODEL	Dimensions mm.						WEIGHTS (Kg)
	A	B	C	D	DNA	DNM	
A-DHR 4-20 FB	71	339	143	338	1" 1/4	1" M	11.5
A-DHR 4-30 FB	71	339	143	338	1" 1/4	1" M	11.7