



MULTINOX-VE + THE NEW GENERATION



VERTICAL MULTI-STAGE CENTRIFUGAL PUMPS
STARITE.IT

MULTINOX-VE+

VERTICAL MULTI-STAGE CENTRIFUGAL PUMPS

Superior hydraulic efficiency, robust and resistant. The MULTINOX-VE+ series of vertical multi-cell centrifugal pumps are the ideal solution for use in lifting stations, above all where optimal performance and silent operation are needed with a compact overall layout.

APPLICATION DATA

- Type of liquid: clean water without suspended solid bodies or abrasive material
- Maximum liquid temperature: 50°C
- Maximum recommended suction height: 6 m with foot valve
- Maximum operating pressure: 9 bar
- 12 bar (versions MULTINOX-VE+ 4-90 and 6-90)
- 16 bar (version MULTINOX-VE+ 4-120)
- 20 bar (versions MULTINOX-VE+ 8-90 and 8-120)

APPLICATIONS

- Lifting and distribution of water in domestic systems, with continuous or intermittent duty

- Pressure booster systems
- Fire fighting systems
- Washing, garden irrigation, fountains

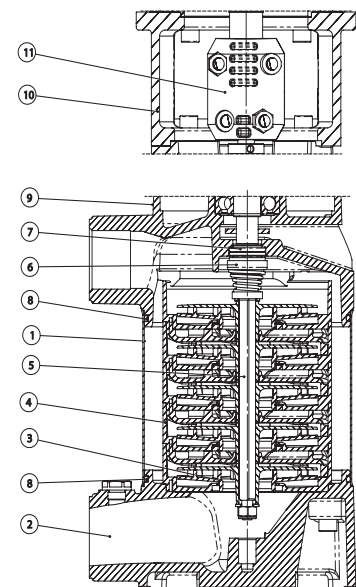
MOTOR

- Closed, ventilated from exterior
- Protection rating IP 44
IP55 MULTINOX-VE+ 8-90
IP55 MULTINOX-VE+ 8-120
- Insulation class F
- Single phase power supply with permanently activated capacitor and thermal cutout protection incorporated in the motor winding
- Three phase power supply with external protection to be fitted by the user
- Rotation speed 2850 rpm
- Continuous duty

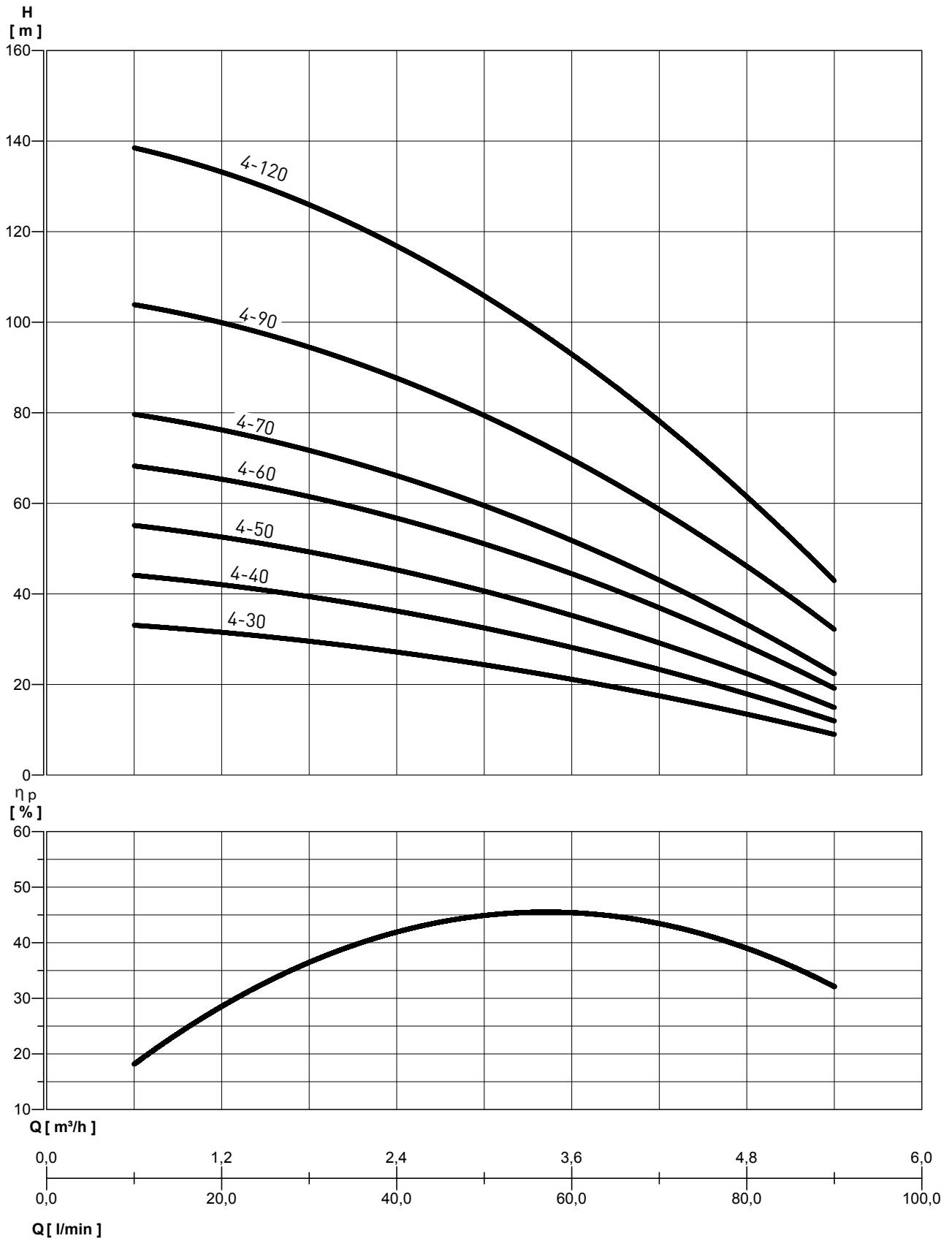


TABLE OF MATERIALS

N.	COMPONENTS	MATERIALS
1	OUTER SLEEVE	Stainless steel EN 10088-1 - X5 CrNi 1810 (AISI 304)
2	SUCTION FLANGE	Cast iron EN GJL 200
3	IMPELLERS	Technopolymer
4	DIFFUSERS	Technopolymer
5	SHAFT (HYDRAULIC SECTION)	Stainless steel EN 10088-1 - X5 CrNi 1810 (AISI 304)
6	MECHANICAL SEAL	Graphite/Silicon Carbide for MULTINOX-VE+ 8-90 and 8-120
7	COUNTERFACE	Al-Oxide/Graphite for MULTINOX-VE+ 8-90 and 8-120
8	SEALS	Rubber Nitril-Butadiene (NRB)
9	MOTOR BRACKET DISCHARGE PORT	Cast iron EN GJL 200
10	MOTOR STOOL	Cast iron EN GJL 200
11	MOTOR COUPLING	Aluminium alloy



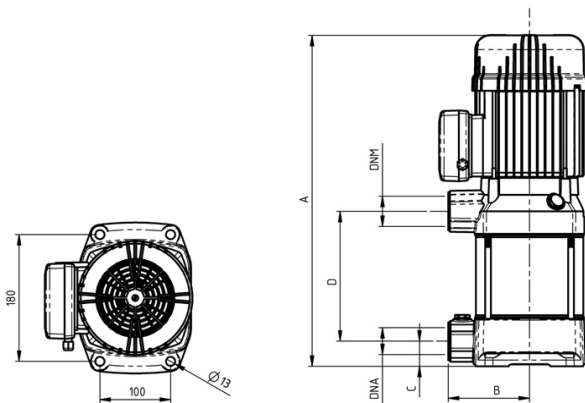
HYDRAULIC PERFORMANCE



MEI ≥ 0,4 - Riferimento MEI ≥ 0,70 - Le informazioni sull'efficienza di riferimento sono disponibili all'indirizzo: www.europump.org/efficiencycharts

PERFORMANCE TABLE

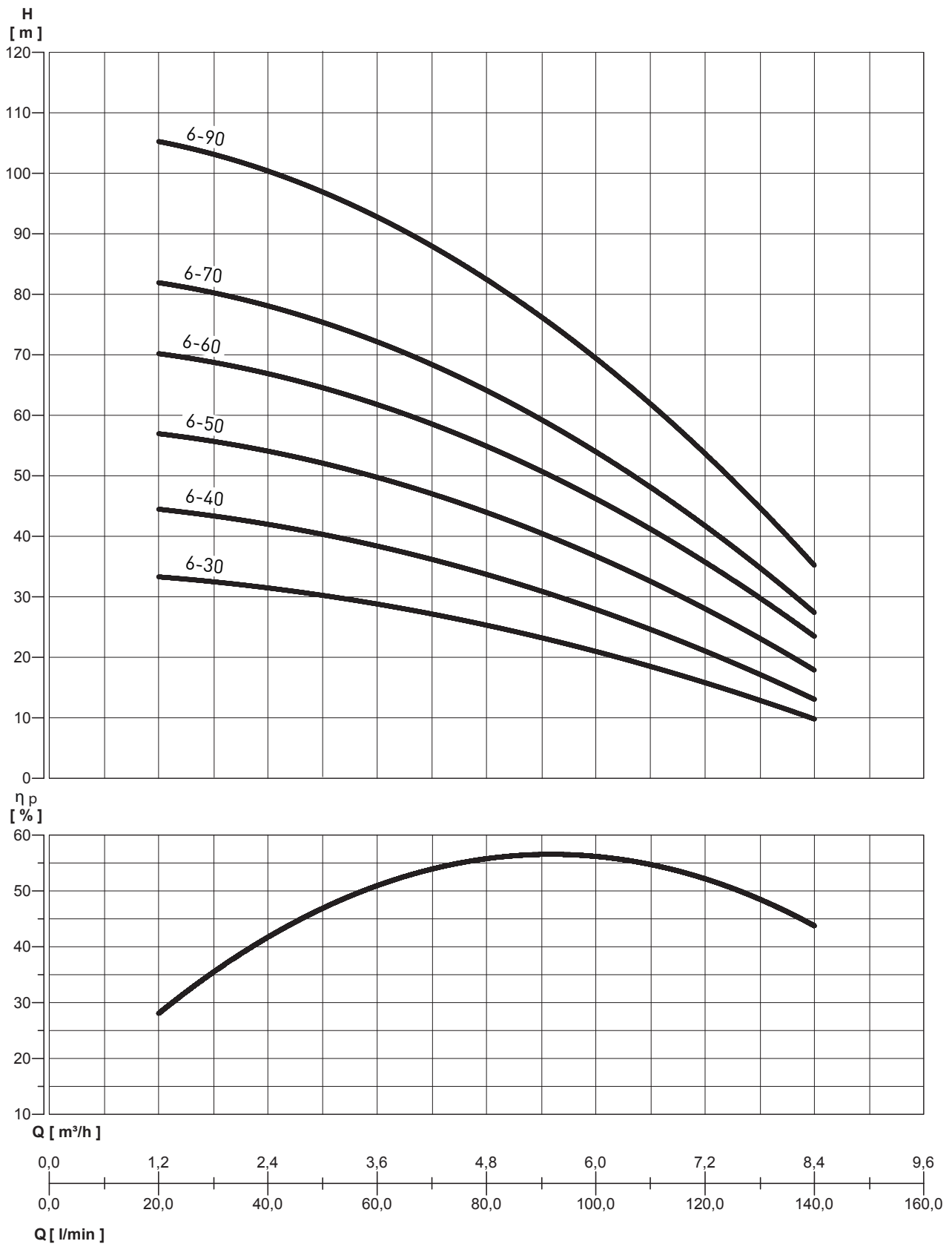
MODEL	Motor output (P2)		Power motor (P1)		VOLTAGE (V)	In (A)	µF	Q	L/min m³/h	10	30	40	50	60	70	90
	HP	kW	HP	kW						0,6	1,8	2,4	3	3,6	4,2	5,4
MULTINOX VE+ 4-30 M	0,68	0,5	1,2	0,86	1~230 3~230/400	3,6	20	m.c.a. / m.c.w.	33	30	27	24	21	17	9	
MULTINOX VE+ 4-30 T			1	0,73												2,6-1,5
MULTINOX VE+ 4-40 M	0,91	0,67	1,4	1	1~230 3~230/400	4,4	20		44	40	36	32	28	23	12	
MULTINOX VE+ 4-40 T			1,3	0,97												3,1-1,8
MULTINOX VE+ 4-50 M	1,1	0,84	1,8	1,3	1~230 3~230/400	5,3	20		55	50	45	41	35	29	15	
MULTINOX VE+ 4-50 T			1,6	1,16												4-2,3
MULTINOX VE+ 4-60 M	1,4	1	2	1,5	1~230 3~230/400	6,6	25		68	62	57	51	44	37	19	
MULTINOX VE+ 4-60 T			1,9	1,4												4,3-2,5
MULTINOX VE+ 4-70 M	1,6	1,17	2,4	1,8	1~230 3~230/400	7,7	25		79	72	67	59	51	43	22	
MULTINOX VE+ 4-70 T			2,3	1,7												5-2,8
MULTINOX VE+ 4-90 T	2	1,5	2,6	1,9	3~230/400	7,1-4	104		95	88	79	69	59	59	32	
MULTINOX VE+ 4-120 T	3	2	3,7	2,7	3~230/400	8,5-4,8	138		127	117	105	92	78	43		



OVERALL DIMENSIONS AND WEIGHTS

MODEL	Dimensions (mm)						Weight (kg)
	A	B	C	D	DNA	DNM	
MULTINOX VE+ 4-30	416	115	35	130	1" 1/4	1" 1/4	19
MULTINOX VE+ 4-40	443	115	35	157	1" 1/4	1" 1/4	21
MULTINOX VE+ 4-50	470	115	35	184	1" 1/4	1" 1/4	23
MULTINOX VE+ 4-60	497	115	35	211	1" 1/4	1" 1/4	25
MULTINOX VE+ 4-70	524	115	35	238	1" 1/4	1" 1/4	27
MULTINOX VE+ 4-90	578	115	35	292	1" 1/4	1" 1/4	28
MULTINOX VE+ 4-120	660	115	35	373	1" 1/4	1" 1/4	30

HYDRAULIC PERFORMANCE

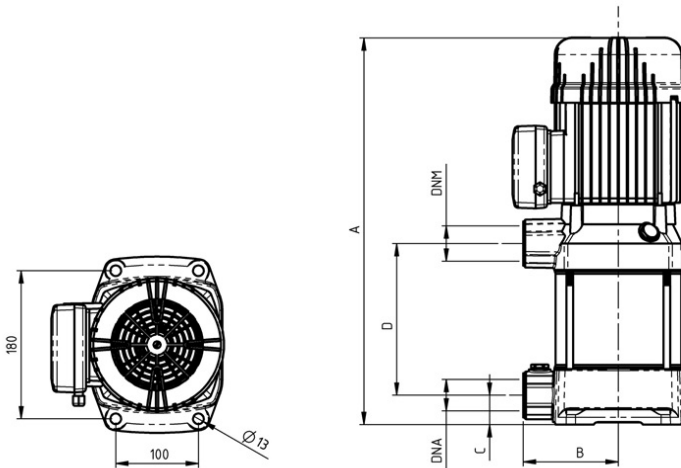


MEI ≥ 0,7 - Riferimento MEI ≥ 0,70 - Le informazioni sull'efficienza di riferimento sono disponibili all'indirizzo: www.europump.org/efficiencycharts

PERFORMANCE TABLE

MODEL	Motor output (P2)		Power motor (P1)		VOLTAGE (V)	In (A)	µF	Q	L/min m³/h	20	40	60	80	100	120	140
	HP	kW	HP	kW						1,2	2,4	3,6	4,8	6	7,2	8,4
MULTINOX VE+ 6-30 M	0,9	0,67	1,4	1	1~230 3~230/400	4,4	20	34	31	28	26	21	16	10		
MULTINOX VE+ 6-30 T			1,3	0,97												
MULTINOX VE+ 6-40 M	1,2	0,9	1,9	1,36	1~230 3~230/400	6,4	25	45	41	38	34	28	21	13		
MULTINOX VE+ 6-40 T			1,6	1,2												
MULTINOX VE+ 6-50 M	1,50	1,1	2,2	1,6	1~230 3~230/400	7	35	58	53	49	44	37	28	17		
MULTINOX VE+ 6-50 T			1,9	1,4												
MULTINOX VE+ 6-60 M	1,8	1,3	2,6	1,9	1~230 3~230/400	8	35	71	66	61	55	47	36	23		
MULTINOX VE+ 6-60 T			2,3	1,7												
MULTINOX VE+ 6-70 T	2	1,5	2,7	2	3~230/400	7,2-3,8		83	77	71	64	55	42	27		
MULTINOX VE+ 6-90 T	3	2	3,5	2,6	3~230/400	8,2-4,5		107	99	92	83	71	54	34		

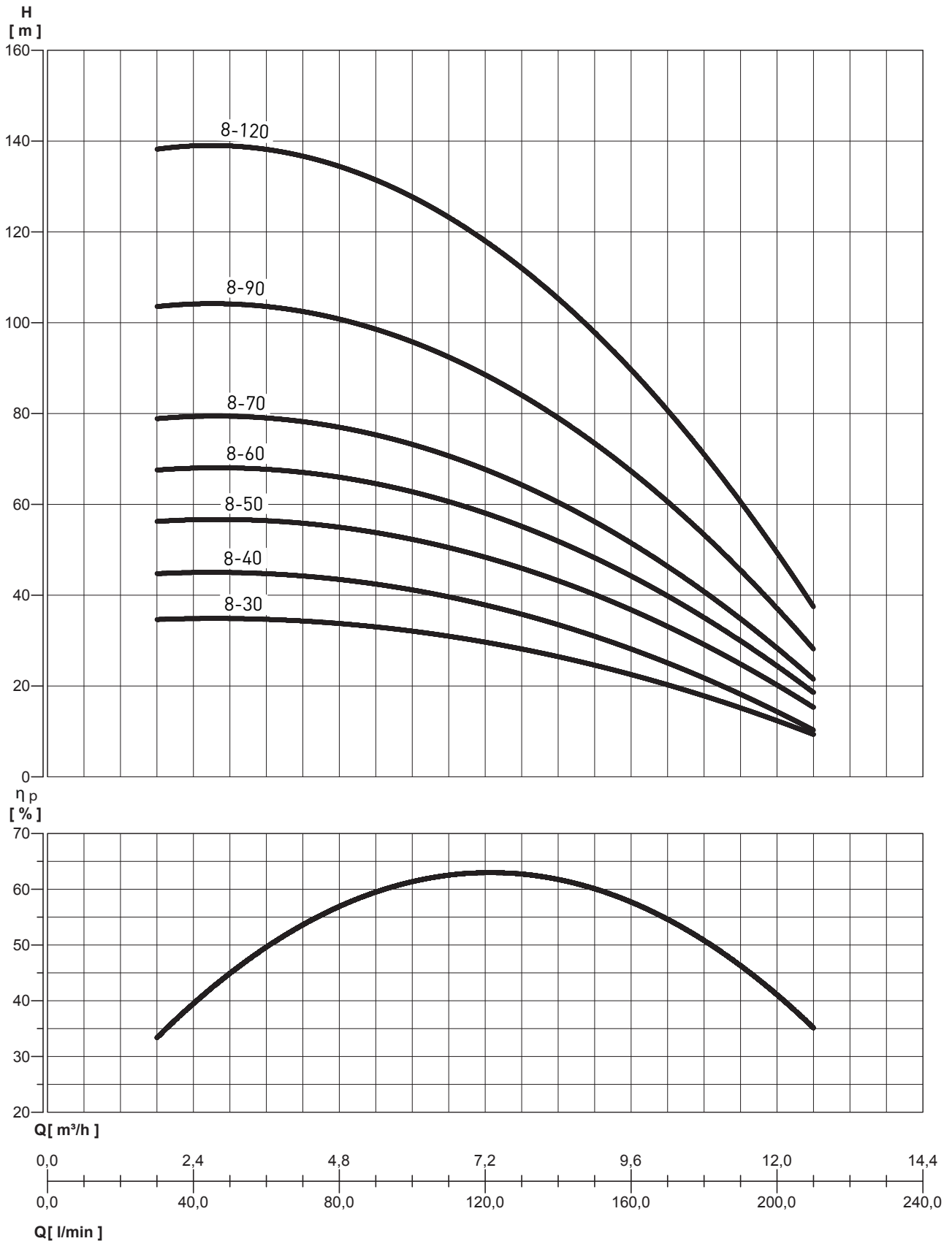
m.c.a. / m.c.w.



OVERALL DIMENSIONS AND WEIGHTS

MODEL	Dimensions (mm)						Weight (kg)
	A	B	C	D	DNA	DNM	
MULTINOX VE+ 6-30	416	115	35	130	1" 1/4	1" 1/4	19
MULTINOX VE+ 6-40	443	115	35	157	1" 1/4	1" 1/4	21
MULTINOX VE+ 6-50	470	115	35	184	1" 1/4	1" 1/4	23
MULTINOX VE+ 6-60	497	115	35	211	1" 1/4	1" 1/4	25
MULTINOX VE+ 6-70	524	115	35	238	1" 1/4	1" 1/4	27
MULTINOX VE+ 6-90	578	115	35	292	1" 1/4	1" 1/4	28

HYDRAULIC PERFORMANCE

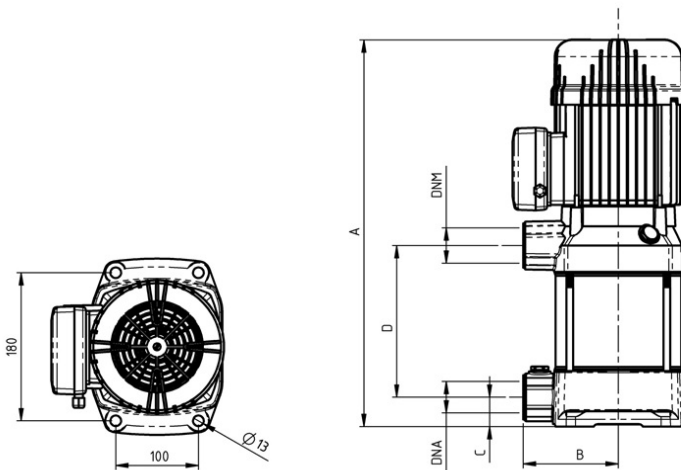


MEI ≥ 0,7 - Riferimento MEI ≥ 0,70 - Le informazioni sull'efficienza di riferimento sono disponibili all'indirizzo: www.europump.org/efficiencycharts

PERFORMANCE TABLE

MODEL	Motor output (P2)		Power motor (P1)		VOLTAGE (V)	In (A)	µF	Q	L/min m³/h	30	60	90	120	150	180	210
	HP	kW	HP	kW						1,8	3,6	5,4	7,2	9	10,8	12,6
MULTINOX VE+ 8-30 M	1,35	1	1,9	1,4	1~230 3~230/400	6,3 4-2,3	20		35	35	33	30	25	18	10	
MULTINOX VE+ 8-30 T			1,7	1,3												
MULTINOX VE+ 8-40 M	4	1,2	2,3	1,7	1~230 3~230/400	7,8 5,7-3,3	25		45	44	42	39	32	20	11	
MULTINOX VE+ 8-40 T			2,3	1,7												
MULTINOX VE+ 8-50 M	2	1,5	3	2,2	1~230 3~230/400	9,5 6-3,7	35		57	56	53	50	40	28	16	
MULTINOX VE+ 8-50 T			2,8	2,1												
MULTINOX VE+ 8-60 T	2,3	1,7	3,3	2,4	3~230/400	6,7-4,7			68	67	64	60	48	34	19	
MULTINOX VE+ 8-70 T	2,5	1,9	3,4	2,5	3~230/400	7-4,9			80	78	74	70	53	40	22	
MULTINOX VE+ 8-90 T	4	3	4,4	3,2	3~230/400	10,2-5,9			104	103	98	90	73	52	29	
MULTINOX VE+ 8-120 T	5,5	4	6,2	4,6	3~230/400	13,5-7,6			139	138	131	120	98	70	38	

m.c.a. / m.c.w.



OVERALL DIMENSIONS AND WEIGHTS

MODEL	Dimensions (mm)						Weight (kg)
	A	B	C	D	DNA	DNM	
MULTINOX VE+ 8-30	416	115	35	130	1" 1/4	1" 1/4	19
MULTINOX VE+ 8-40	443	115	35	157	1" 1/4	1" 1/4	21
MULTINOX VE+ 8-50	470	115	35	184	1" 1/4	1" 1/4	23
MULTINOX VE+ 8-60	497	115	35	211	1" 1/4	1" 1/4	25
MULTINOX VE+ 8-70	524	115	35	238	1" 1/4	1" 1/4	27
MULTINOX VE+ 8-90	730	115	35	292	1" 1/4	1" 1/4	36
MULTINOX VE+ 8-120	855	115	35	373	1" 1/4	1" 1/4	39



Pentair Water Italy | Via Masaccio | 13 56010 LUGNANO (PI) | ITALY | starite.it

Pentair Sta-Rite is a trademark, or registered trademark of Pentair or its subsidiaries in the United States and/or other countries.

Because we are continuously improving our products and services, Pentair reserves the right to change specifications without prior notice.

Pentair is an equal opportunity employer.

NV260A790 ED. IT - Rev.0 - 01/18 © 2018 Pentair Water Italy. All Rights Reserved.